



Model COM-ST4SC 4-CY Stationary Compactor



Standard Specifications

• Clear Top Opening	67.75" x 58.0"
• Cycle Time	50 Seconds
• Normal Force (Total)	50,868 Pounds
• Maximum Force (Total)	56,520 Pounds
• Normal Ram Face Pressure	30.3 PSI
• Maximum Ram Face Pressure	33.6 PSI
• Ram Penetration	14 Inches
• Motor	15 HP
• Pump	19 GPM
• Normal Pressure (Hydraulic)	1,800 PSI
• Maximum Pressure (Hydraulic)	2,000 PSI
• Cylinder Stroke	82 Inches
• Cylinder Bore	6 Inches
• Rod Diameter	4 Inches
• Reservoir Capacity	50 Gallon

*ALL MEASUREMENTS ARE NOMINAL

CMPST4-1

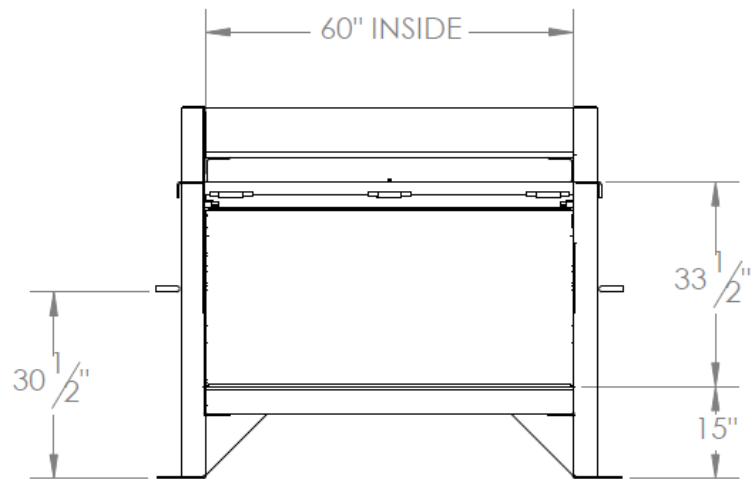

FRONT VIEW

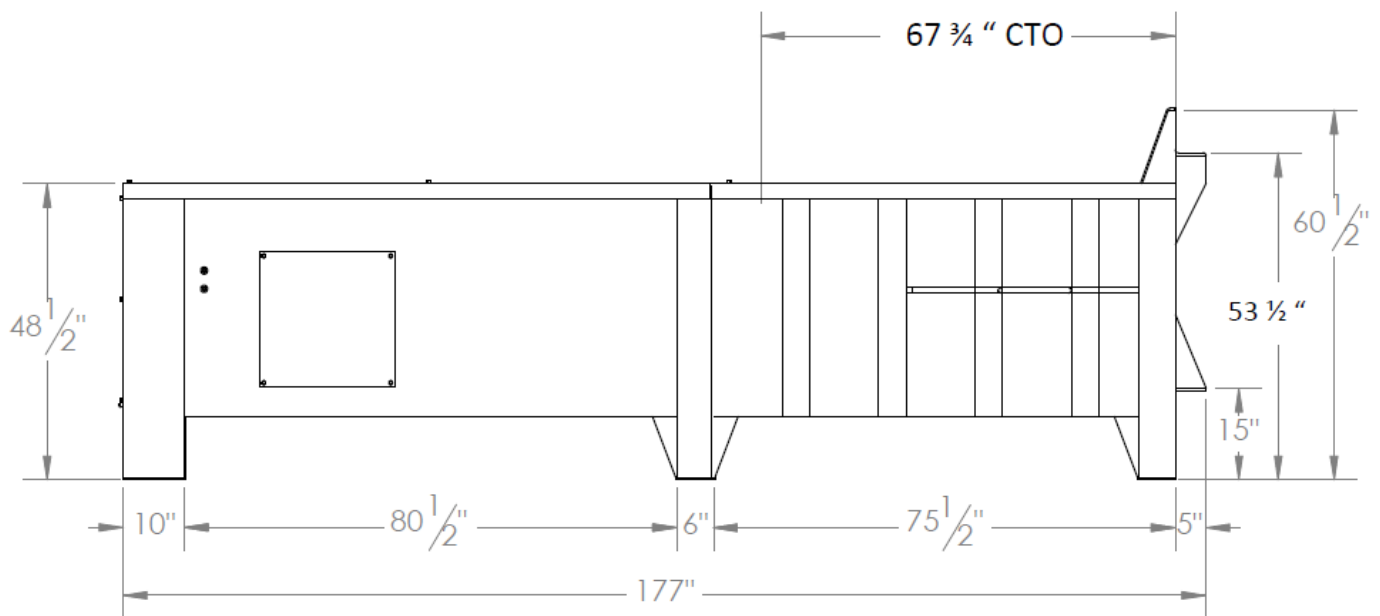

SIDE VIEW