

6" Hydraulically Driven Submersible System
Model H6TP-D2.9L4
Size 6" Trash Pump

Holland® Pump Company
Corporate Office: 7312 Westport Place
West Palm Beach, FL 33413
USA
1-800-451-0769
www.hollandpump.com

PUMP SPECIFICATIONS

Size: 6" Trash Pump

Volute: Fabricated Steel (optional stainless steel and special abrasion resistant steel volutes are available)

Impeller: Semi-open, 3 Vane. (optional stainless steel or special abrasion resistant steel impellers are available)

Solids: Handles 3" diameter compressible spherical solids

Impeller Shaft: High strength steel

Seal: Rotary Mechanical, oil-lubricated, carbon & ceramic (tungsten carbide or silicon carbide seals are available as an option)

Hydraulic System

Hydraulic Reservoir level: 30 gallon capacity with 10 micron spin-on oil filter. Automatic shutdowns for over-temperature or low oil

Hydraulic Oil: Petroleum based AW68 Furnished standard (optional canola bio-degradeable oil or mineral based non-toxic inherently bio-degradeable oil available)

Hydraulic Pump: Denison vane type positive displacement pump with pilot operated Denison relief valve

Hydraulic Motor: Vickers vane type positive displacement motor

Heat Exchanger: Double row, SCH 40 pipe with integral intake basket (optional engine mounted oil cooler available)

Hydraulic Hose: 50' set of SAE 100R2, two wire braid high-pressure hose

Pump Head Fail Safe Pressure Relief System: Available as an option to protect system against improper connection or interruption of biodegradable oil flow from pump head to power unit

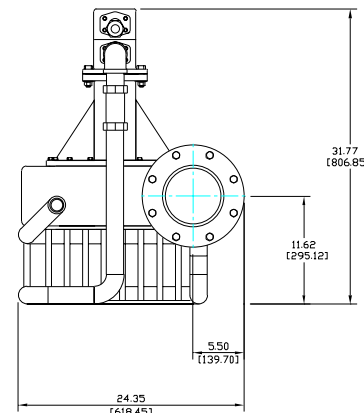
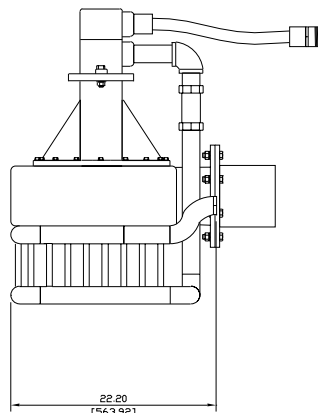

Holland 6" Trash Pump

ENGINE SPECIFICATIONS

Model: Deutz D2.9L4, Tier 4 Final

Type: 4 Cylinder, 4 Stroke, Naturally Aspirated, Liquid Cooled Diesel Engine

Displacement: 2.9L (177cu.in.)

Governor: Electronic

Lubrications: Forced Circulation

Air Cleaner: Dry Type with Replaceable Element

Lube Oil Capacity: 2.4 U.S. Gallons (9L)

Coolant Capacity: 2.1 U.S. Gallons (8L)

Fuel Tank: Integral 68 U.S. Gallon Capacity (#2 Diesel Fuel)

Full Load Operating Time: 60 Hours Minimum @ 2000 PSI

Starter: 12 Volt, 2.0 kW

Standard Features: Skid, SAE Flywheel Housing, SAE Flywheel, SAE B Pump Adaptor, Standard Instrument Panel: Engine Temperature and Low Oil Pressure with optional Gauge, Key Start, and Hour Meter

Optional Features: Site or DOT Highway Trailer, Automatic Remote Start/Stop, HANS (Holland Automatic Notification System), NEMA 4 Instrument Package Covering: Air Filter, Fuel Filter, Engine Temperature, Fuel Level, Engine Oil Pressure, Hour Meter, Amp Meter, Hydraulic Oil Pressure

Deutz Published Performance: Maximum Continuous Power: 50 BHP (37.3 kW) @ 2600 RPM

H6TP @ 2000 PSI	Capacity of Pump in U.S. Gallons per Minute (gpm) (Continuous Performance)
20' / 9.14m	1000/158
10' / 4.57m	1330/182

Holland® Pump Company
Corporate Office: 7312 Westport Place
West Palm Beach, FL 33413
USA
1-800-451-0769
www.hollandpump.com

6" Hydraulically Driven Submersible System
Model H6TP-D2.9L4
Size 6" Trash Pump

Approximate Dimensions
Powered by Deutz D2.9L4 Diesel Engine, Optional
Single Axle Trailer Shown

	Skid Base	DOT Trailer	Pump
Net Weight (lbs)	2202	2502	335
Shipping Weight (lbs)	2302	N/A	N/A
Export Crate Size (cu. ft)	107	N/A	10

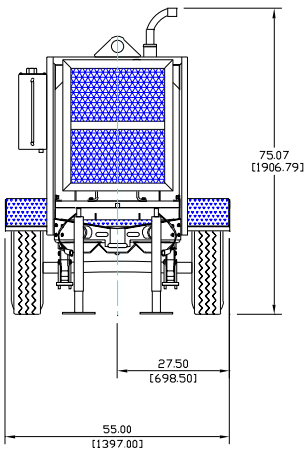
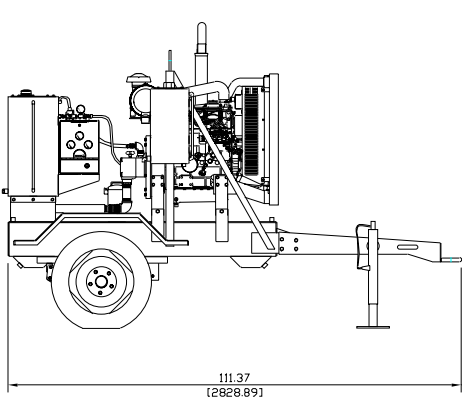

TOTAL HEAD
PSI FT

Performance Curve Model: H6TP-D2.9L4
Size: 6" Trash Pump

