



## Name: 4" Compressor-Assisted Solids Handling Pump

## Model: 4JSC-MP-SK

With its heavy-duty cast-iron construction and fast priming capabilities, the Thompson 4JSC-MP-SK solidshandling end suction centrifugal pump leads the industry in construction, industrial and municipal applications. The Thompson 4JSC-MP-SK is designed for moderate flows up to 1,240 gpm and heads up to 144 feet making it perfect for sewage bypass pumping or general construction dewatering.



Photo shown may not be exact model.

Consult factory for other versions & options including site trailers, sound attenuation, etc.

Pump End Materials	
<b>Pump Casing</b>	Heavy-duty class 30 ductile iron.
<b>Impeller &amp; Wear Ring</b>	Dynamically balanced, non-clogging, enclosed, 65-45-12 ductile iron with rear-equalizing vanes to reduce axial loading and prolong seal and bearing life; diameter 10".
<b>Mechanical Seal</b>	Dry-running, grease or oil lubricated with Tungsten Carbide rotating and Silicon Carbide stationary seal faces. Single inside mounted, non- pusher type with self-adjusting elastomeric bellows. Other components are 304 stainless steel and Viton.
<b>Head</b>	Rugged, back pull out design, heavy-duty class 30 cast iron with tapered bore design.
<b>Bearings</b>	Heavy-duty grease lubricated to carry both axial and radial loads.
<b>Bearing Frame</b>	Heavy-duty class 30 ductile iron.
<b>Shaft</b>	SAE 1144 with renewable 416 stainless steel shaft sleeve.

Technical Specifications			
Suction Size	4 in (10.16 cm)	Approximate Dry Weight	5,220 lbs (2,367.75 kg)
Discharge Size	4 in (10.16 cm)	Best Efficiency	70%
Maximum Solids Handling	3 in (7.62 cm)	Maximum Operating Speed	2,000 rpm
Maximum Operating Temperature	200° F (93.33° C)	Maximum Operating Pressure	62.3 psi (429.8 kPa)

Fuel Tank Options*		Isuzu	Deutz
Modular (M)	100 Gal	79 Hours	79 Hours
Double-Wall (D)	75 Gal	57 Hours	56 Hours
Double -Wall Large Capacity (Z)	150 Gal	107 Hours	106 Hours

\*Contact factory for fuel tank sizes not listed above.

**Thompson Pump and Manufacturing Co., Inc.**  
4620 City Center Drive, Port Orange, FL 32129 USA  
www.thompsonpump.com

Nationwide 800-767-7310 • International +1-386-767-7310  
sales@thompsonpump.com  
May-20

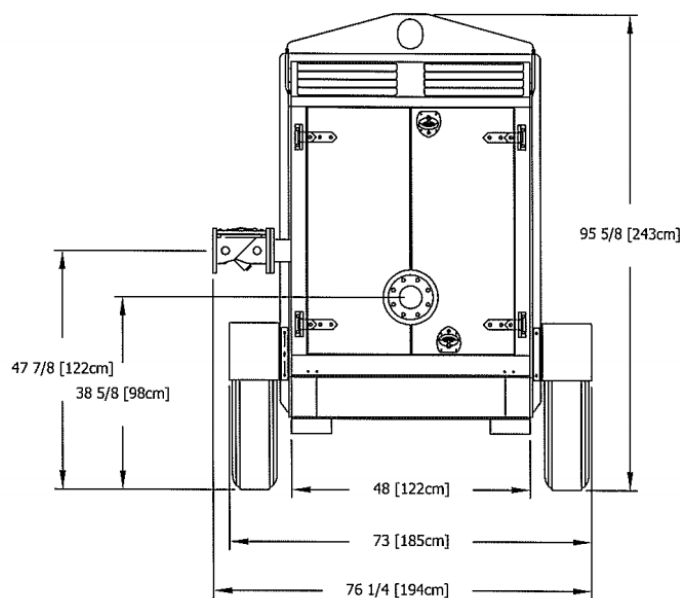
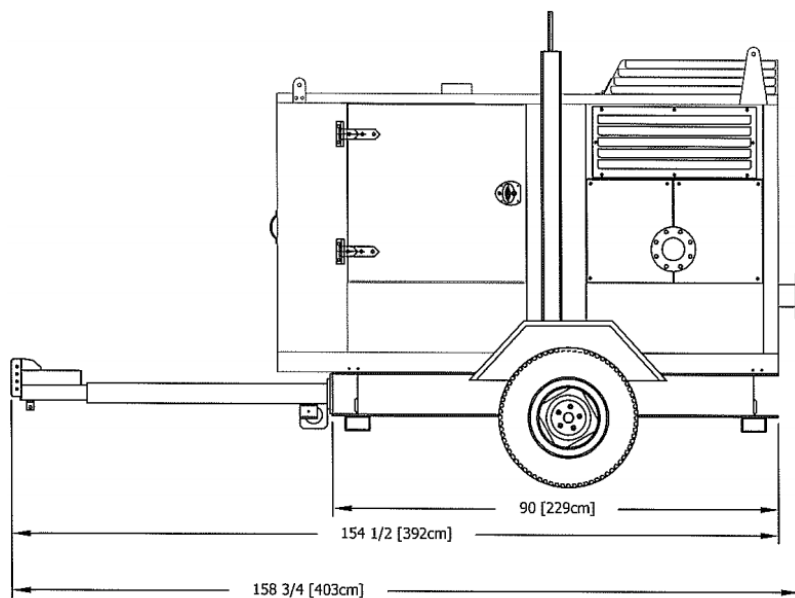
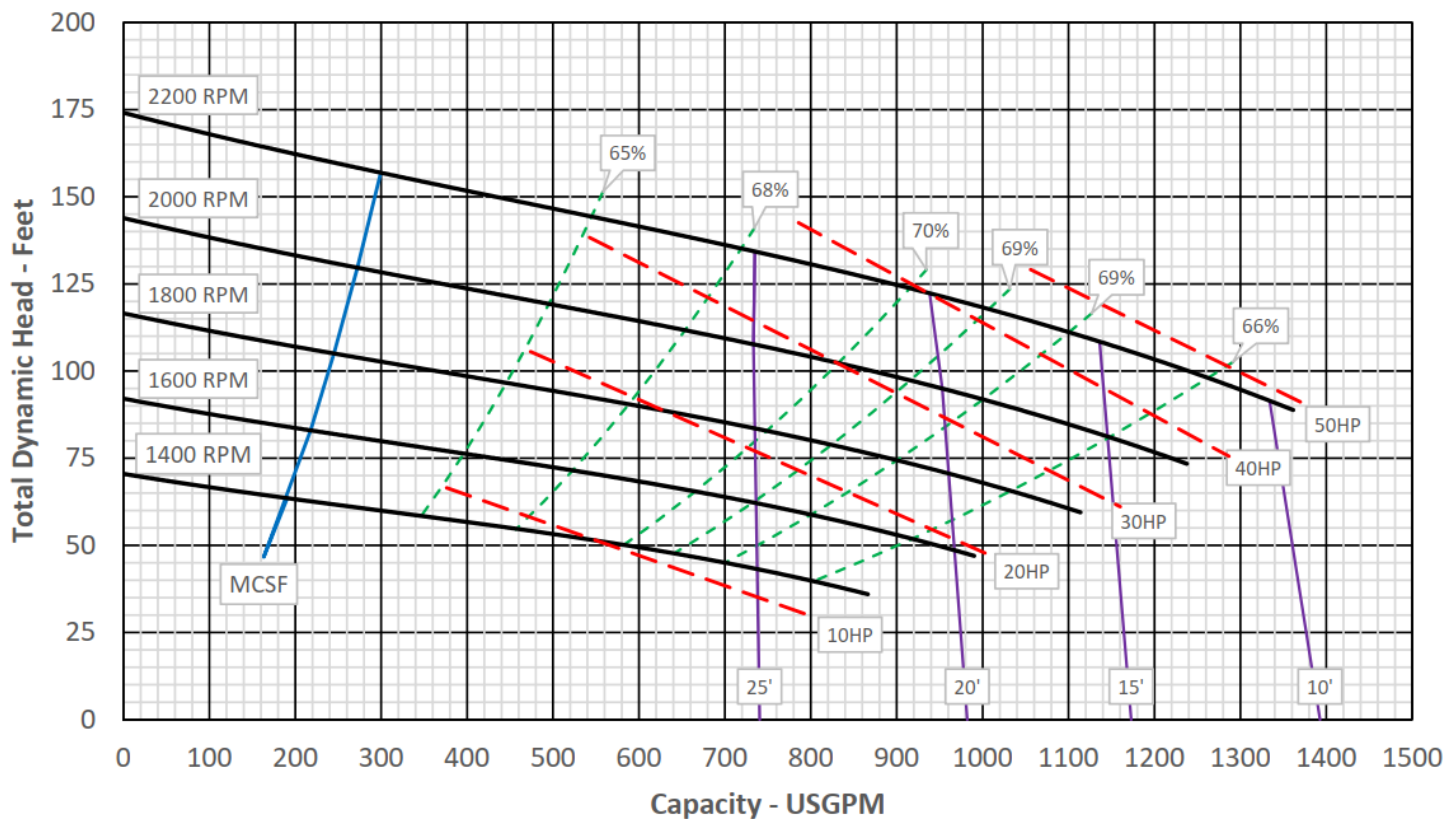

Isuzu 4LE2T—43 hp @ 2,400 rpm				
Typical Operating Speed	2,000 rpm	Engine Speed	Fuel Economy	Run Time*
Maximum Head	144 ft (43.89 m)	2,000 rpm	0.386 lb/hp-hr	43 hrs
Maximum Flow Capacity	1,240 gpm (281.48 m³/hr)	1,800 rpm	0.378 lb/hp-hr	62 hrs
Maximum Fuel Consumption	2.31 gph (8.74 L/hr)	1,600 rpm	0.372 lb/hp-hr	79 hrs

Deutz D2.9L4 — 40 HP @ 2,200 rpm				
Typical Operating Speed	2,000 rpm	Engine Speed	Fuel Economy	Run Time*
Maximum Head	144 ft (43.89 m)	2,000 rpm	0.390 lb/hp-hr	45 hrs
Maximum Flow Capacity	1,240 gpm (281.48 m³/hr)	1,800 rpm	0.381 lb/hp-hr	59 hrs
Maximum Fuel Consumption	2.22 gph (8.4 L/hr)	1,600 rpm	0.375 lb/hp-hr	79 hrs

\*Engine run times calculated based on a 100 gallon fuel tank.

Specifications and illustrations are subject to revision without notice and without incurring any obligation for previous or subsequent equipment sold. Thompson Pump (ISO 9001:2015) makes no representation regarding the completeness or accuracy of this information and is not liable for any direct or indirect damages arising from or relating to this information or its use. Capacity & Head are shown for comparative purposes. Consult Thompson factory for exact capabilities.

Thompson Pump's Silent Knight Canopy is designed to fully contain the pump and engine in a lockable enclosure. This enclosure will reduce noise levels at, or below 74 dBA when measured from a distance of 7 meters. With a modular design, this canopy can be added to many units after the unit has already been in operation.



### Materials

<b>Outer Shell</b>	18 Gauge Galvaneal Steel
<b>Frame</b>	14 Gauge Galvaneal Steel
<b>Insulation</b>	8 pound mineral wool with laminate face. 1 1/2" thick, 1" thick open-cell foam sound collars around piping
<b>Interior Lining</b>	Perforated aluminum 0.05 thick, 30 holes per in <sup>2</sup> , 1/8" diameter
<b>Coating</b>	1-3 mil powder coating available in a variety of colors
<b>Latches</b>	Vector "T" handle key locking with adjustable cam (M27-LF-20-363-22P)
<b>Hinges</b>	Long hinge strap (M27-LF-20-363-21-2) Short hinge strap (M27-LF-20-363-21-3)
<b>Fasteners</b>	<ul style="list-style-type: none"> <li>• Hex head bolts 304 stainless</li> <li>• Hex nuts fine thread 304 stainless</li> <li>• Flat washers 304 stainless</li> <li>• Hex head sheet metal screws or self drilling screws 304 stainless</li> <li>• Aluminum pop rivets</li> <li>• All other bolts, screws or fasteners should be 304 stainless</li> <li>• Hinge grease fittings 304 stainless</li> </ul>

**Thompson Pump and Manufacturing Co., Inc.**  
4620 City Center Drive, Port Orange, FL 32129 USA  
www.thompsonpump.com

Nationwide 800-767-7310 • International +1-386-767-7310  
Fax 386-761-0362  
sales@thompsonpump.com

Apr-20

Specifications and illustrations are subject to revision without notice and without incurring any obligation for previous or subsequent equipment sold. Thompson Pump (ISO 9001:2008) makes no representation regarding the completeness or accuracy of this information and is not liable for any direct or indirect damages arising from or relating to this information or its use.